

## Magnetic Locking Solenoid

(Reference #PA0063)

### Description:

The solenoid is energized to move to the latched position with a short voltage pulse. Once the voltage is removed, the permanent magnet maintains the solenoid in the latched position. The solenoid is spring returned to the de-latched position by providing a short, reverse polarity voltage pulse, which cancels the permanent magnet field. Strokes and forces are flexible depending upon solenoid size.



### Features:

- Compact design
- Low power consumption, battery operable
- Fast reaction speed
- Configurable for push or pull operation

### Specifications:

**English** (metric as applies)

Stroke (can be designed to specification)	.157 in (4 mm)
Resistance at 20°C	16 Ω
Supply Voltage	9 Vdc
Reaction Speed	12-15 ms
Minimum Coil Operating Voltage	4.0 Vdc
Maximum Coil Operating Voltage	9.9 Vdc
Force to Extend (4.0 Vdc)	.786 lb (3.5 N)
Force Retracted (4.8 Vdc)	1.506 lbs (6.7 N)

### Possible applications:

- Electric locks
- Spool lock
- Vending equipment
- Sorting/filling equipment
- Business machines
- ATM machines
- Battery operated locks
- Medical equipment

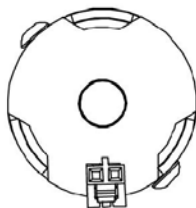
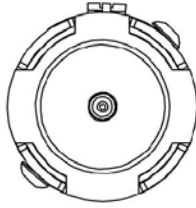
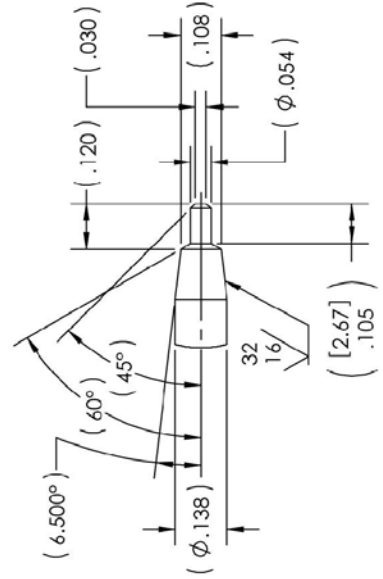
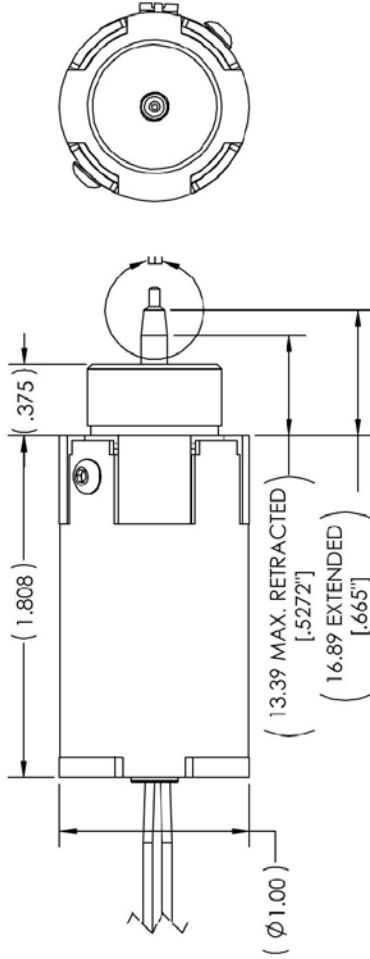
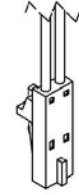
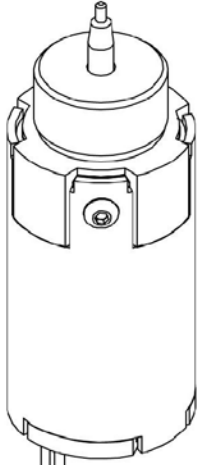

NOTES:

TYPE: MAGNETIC LOCKING SOLENOID  
 SPECIFICATIONS:

MIN COIL OPERATING VOLTAGE: 4.0 VDC  
 MAX COIL VOLTAGE: 9.9 VDC  
 STROKE: 4mm  
 FORCE TO EXTEND (4.0 V) 3.5N  
 FORCE RETRACTED (4.8 V) 6.7N

LEADS:

RED POSITIVE VOLTAGE TO EXTEND (PIN 1)  
 WHITE POSITIVE VOLTAGE TO RETRACT (PIN 2)  
 WIRE GAGE: 24AWG  
 WIRE LENGTH: 18CM

UNLESS OTHERWISE SPECIFIED:		NAME	DATE
DRAWN	JDM	9/9/9999	
CHECKED			
ENG APPR.			
MFG APPR.			
QA			
DIMENSIONS ARE IN INCHES		TITLE: TLX TECHNOLOGIES	
FRACTIONS: 1/16" MINIMUM		TITLE: LATCHING SOLENOID	
ANGULAR: 1°		SIZE DWG. NO. REV	
TWO PLACE DECIMAL ±.01		B PA0063-WEB	
THREE PLACE DECIMAL ±.005		SCALE: 2:1 WEIGHT: SHEET 1 OF 1	
NEAREST QUADRANT TOLERANCING PER ASME Y14.5			
MATERIAL		COMMENTS:	
FINISH			
DO NOT SCALE DRAWING			

PROPRIETARY AND CONFIDENTIAL  
 THE INFORMATION CONTAINED IN THIS DRAWING IS THE SOLE PROPERTY OF TLX TECHNOLOGIES. ANY REPRODUCTION IN PART OR AS A WHOLE WITHOUT THE WRITTEN PERMISSION OF TLX TECHNOLOGIES IS PROHIBITED.