

## PA0005: Latching Solenoid with Residual Magnetism Technology

### Description

A linear on/ off solenoid with a built in latching feature that holds the solenoid in the energized position. The solenoids latching feature utilizes TLX's residual magnetism technology and therefore does not require the use of continuous current or permanent magnets to hold in the selected position. Strokes and latching force are flexible depending upon solenoid size. Suitable for use in vehicle locks, latches, disconnects and safety cutout applications.



### Features:

- Compact design
- High latching forces
- Low power consumption
- Can be optimized for specific load holding capability & package size

### Typical Specifications:

### English (metric as applies)

Stroke (can be designed to specification)	.098 inches (2.5mm)
Latching force	9 lbs (40 N)
Response time	<10msec
Release Current	1 amp
Release Response	3msec
Release Voltage	12VDC
Durability	>500K cycles
Connector type	As required

**Typical Specifications:**

Stroke (can be designed to specification) .098 inches (2.5mm)  
 Latching force 9 lbs (40 N)  
 Response time <10msec  
 Release Current 1 amp  
 Release Response 3msec  
 Release Voltage 12VDC  
 Durability >500K cycles  
 Connector type As required

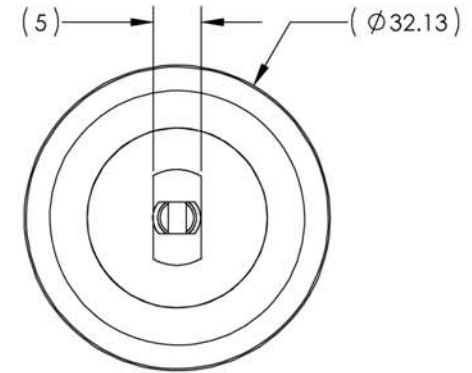
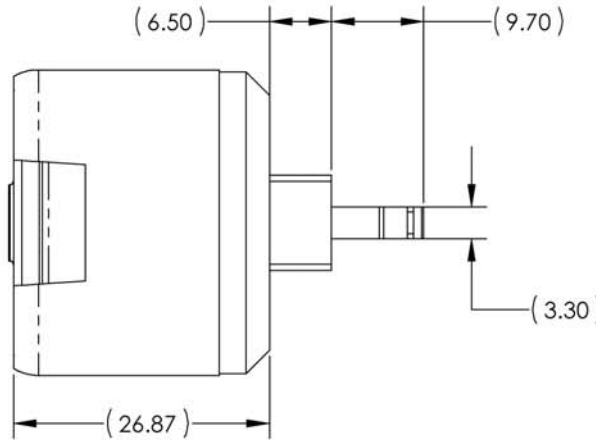
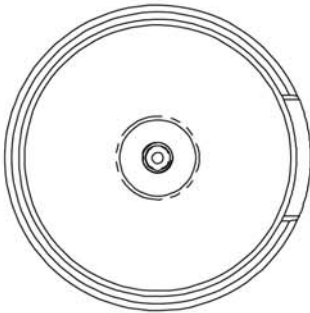
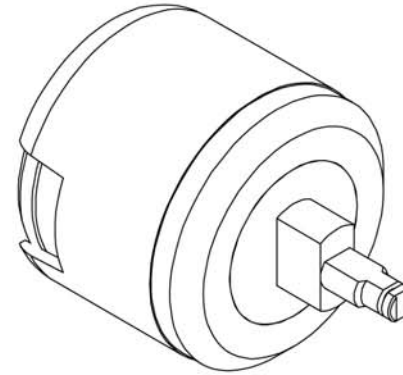

UNLESS OTHERWISE SPECIFIED:	NAME	DATE
DIMENSIONS ARE IN INCHES	JDM	9/9/9999
TOLERANCES:		
ANGULAR: 1*		
TWO PLACE DECIMAL ±.01		
THREE PLACE DECIMAL ±.005		
INTERPRET GEOMETRIC TOLERANCING PER:		
MATERIAL		
FINISH		
DO NOT SCALE DRAWING		

TLX TECHNOLOGIES		
TITLE:		
LATCHING SLOENOID		
SIZE	DWG. NO.	REV
B	PA0005-WEB	A
SCALE: 2.5:1 WEIGHT:		SHEET 1 OF 1

**PROPRIETARY AND CONFIDENTIAL**  
 THE INFORMATION CONTAINED IN THIS DRAWING IS THE SOLE PROPERTY OF TLX TECHNOLOGIES. ANY REPRODUCTION IN PART OR AS A WHOLE WITHOUT THE WRITTEN PERMISSION OF TLX TECHNOLOGIES IS PROHIBITED.